



Model No. WDF4830

10/UK/ WDF4830 Version 07/10 Part No. T22-30454
REMINGTON® is a Registered Trade Mark of Spectrum
Brands, Inc., or one of its subsidiaries
VARTA Consumer Batteries GmbH & Co. KGaA
Alfred-Krupp-Str. 9
73479 Ellwangen
Germany
www.remington-europe.com
© 2010 SBI



REMINGTON

smooth & silky®



CORDLESS
LADY SHAVER



REMINGTON |

CORDLESS LADY SHAVER



ENGLISH

Thank you for choosing Remington®. Our products are designed to meet the highest standard of quality, functionality and design. We hope you enjoy using your new Remington® product. Please read the instructions for use carefully and keep them in a safe place for future reference.



CAUTION

- ◆ Use this appliance only for its intended use as described in this manual.
- ◆ Do not use this product if it is not working correctly, if it has been dropped or damaged, or dropped into water.



DESCRIPTION

1. Head assembly
2. Head release button
3. On/Off button
4. 2 hypoallergenic flexing shaver foils
5. Bikini trimmer comb guard
6. Flexible trimmer
7. Charging indicator light
8. Moisturising Massage strip with Aloe Vera
9. Charging stand
10. Cleaning brush
11. Mains adaptor



GETTING READY

Be patient when first using your shaver, as with any new product, it may take a little while to familiarise yourself with the product. Take the time to acquaint yourself with your shaver, as we are confident you will receive years of enjoyable use and complete satisfaction.

■ INSTRUCTIONS FOR CHARGING

Always ensure that your hands, trimmer and mains adaptor are dry before charging. Before using your Remington® lady shaver for the first time, charge for 24 hours. For subsequent uses, charge for 20 hours before use. One full charge allows for 30mins of cordless usage time.

Use product until the battery is low. This is indicated by the shaver running distinctly slower.

ENGLISH

Your shaver cannot be overcharged. However, if the product is not going to be used for an extended period time (2-3 months), unplug it from the mains and store. Fully recharge your shaver when you would like to use it again.

To preserve the life of your batteries, let them run out every six months then recharge for 20 hours.

■ CHARGING CAUTIONS:

- ▶ Do not attach the power cord to the mains with wet hands.
- ▶ Always charge shaver in a cool, dry place.
- ▶ Do not charge the shaver in close proximity to water.
- ▶ The shaver can be attached to an electrical outlet voltage of 220V – 240V



HOW TO USE



Your shaver is suitable for legs, underarms and the bikini area.
It can be used dry or in the shower.

■ FOR REGULAR SHAVING

- ▶ Remove protective cap before shaving.
- ▶ Turn the shaver on.
- ▶ Hold the shaver at a right angle to your skin and move the shaver against the direction of the hair growth.
- ▶ After shaving, turn shaver off.

◆ Note: Before dry shaving, make sure that the area is clean, dry and free from creams or oils

■ FOR LONGER HAIRS

If you have not shaved for a while, use the trimmer before shaving. This will help you achieve a more effective shaving result.

- ▶ Hold the shaver with the trimmer facing your leg and slightly tilted towards you (approximately at a 45° angle).
- ▶ Move the trimmer slowly against the direction of the hair growth.

■ TRIMMING AND SHAPING

- ▶ Attach the bikini trimmer attachment.
- ▶ Hold the shaver at a right angle to your skin and press down gently.
- ▶ Edge and shape the areas as desired.

■ FOR BEST SHAVING PERFORMANCE

- ▶ We recommend that you use your new shaver daily for two or three weeks to allow time to find the optimum shaving methods for your particular type of hair growth patterns.

◆ CAUTION

- ▶ If your skin is easily irritated by shaving, or you suffer from skin allergies, you should test a section of your arm or leg before using the shaver.



CARE FOR YOUR SHAVER

To ensure long lasting performance of your shaver, clean the head assembly regularly. The easiest and the most hygienic way to clean the shaver is by rinsing the shaving head after use with warm water. Always keep the protective cap on the shaving head when the shaver is not in use.

AFTER EACH USE

- ▶ Ensure the shaver is turned off.
- ▶ Press the side release button to slip open the head assembly.
- ▶ Blow any loose debris from the foil.
- ▶ Brush or rinse the accumulated hair from the main body of the shaver, head assembly and cutter assembly.
- ▶ Leave the head assembly open to let the shaver dry completely.

NOTE:

- ▶ The shaver is suitable for use in the bath and shower.
- ▶ Do not rinse with water hotter than 70°C.
- ▶ Make sure that the power supply and the cord do not get wet.
- ▶ Do not completely submerge the shaver in water.
- ▶ Ensure that the shaver is turned off and unplugged from the mains when cleaning.
- ▶ Do not clean the shaving foils with the brush.
- ▶ At regular interval, put a drop of sewing machine oil onto the foils and cutters head.

REPLACING YOUR FOILS AND CUTTERS

To ensure the continued highest quality performance from your shaver, we recommend that the foil and cutter are replaced every 6 months. These can be obtained from our nearest Remington® Service Centre.

Signs that your foils and cutters need replacing:

- ▶ Irritation: As foils get worn, you may experience skin irritation.
- ▶ Pulling: As the cutters wear, your shaver may not feel as close and you may feel your cutter pulling your hair.
- ▶ Wear through: You may notice that the cutters have worn through the foils.

ENGLISH

■ TO REPLACE THE FOIL

- ▶ Ensure the shaver is switched off.
- ▶ Press the side release button to slip open the head assembly.
- ▶ Gently push the small plastic tabs at either end of the foil carrier.
The foils should then easily detach from the head assembly.
- ▶ To reassemble, snap the replacement foil carrier into position.
- ▶ Close the head assembly.

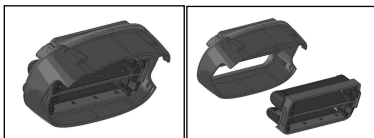

◆ CAUTION

- ▶ Only hold the plastic to prevent damage to the foil.
- ▶ Do not press on the foil when replacing.

■ TO REPLACE THE CUTTERS

- ▶ Ensure the shaver is switched off and open the head assembly (as above). (Diagram G)
- ▶ To remove cutter, grasp cutter between thumb and forefinger and pull upward. (Diagram J)
- ▶ To reassemble cutter, place cutter onto oscillator tip. Gently push down clicking into position.

ENGLISH



IMPORTANT SAFETY INSTRUCTIONS

WARNING – TO REDUCE THE RISK OF BURNS, ELECTROCUTION, FIRE, OR INJURY TO PERSONS:

- ▶ An appliance should never be left unattended when plugged into a power outlet.
- ▶ Keep the power plug and cord away from heated surfaces.
- ▶ Make sure the power plug and cord does not get wet.
- ▶ Do not plug or unplug the shaver with wet hands.
- ▶ Do not use the product with a damaged cord. A replacement can be obtained via the Remington® Service Centres.
- ▶ Store the product at a temperature between 15°C and 35°C.
- ▶ Always unplug from the mains when cleaning or when being used under running water.
- ▶ Only use the parts supplied with this appliance. Use of non Remington parts with this product may give rise to a hazardous condition.
- ▶ This product is for cordless use only. Do not use your shaver while it is plugged into the mains.
- ▶ Keep this product out of reach of children. The use of this appliance by persons with reduced physical, sensory or mental capabilities or lack of experience and knowledge can give cause to hazards. Persons responsible for their safety should give explicit instructions or supervise the use of the appliance.



BATTERY REMOVAL

The appliance must be disconnected from the supply mains when removing the battery. The battery must be removed from the appliance before it is scrapped. The battery is to be disposed of safely.

1. Unscrew and separate the top and bottom housing.
2. Unscrew inner frame.
3. Remove the batteries from the product. Contact your local authorities for proper disposal.

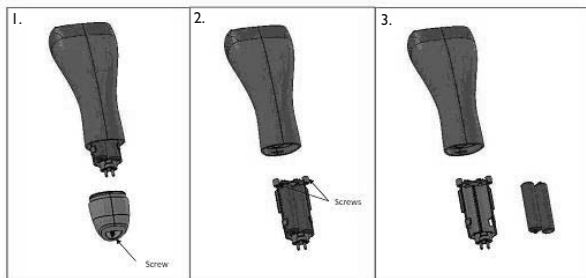

ENGLISH



PROTECT THE ENVIRONMENT

This appliance contains an environmentally friendly rechargeable Nickel Metal Hydride battery. Do not dispose the appliance or the battery in the household waste as restrictions exist in most countries. Adhere to the national or local regulations for collection and disposal that apply for your specific location. In case you are required to remove the battery from the appliance for separate disposal see the instructions in the 'Battery Removal' section on how to open housing.

⚠ **CAUTION:** Do not put in fire or mutilate your battery packs as they may burst or release toxic materials.



For further information on recycling see www.remington-europe.com

2
years

SERVICE & WARRANTY

This product has been checked and is free of defects. We warrant this product against any defects that are due to faulty material or workmanship for a 2 year period from the original date of consumer purchase.

If the product should become defective within the warranty period, we will repair any such defect or elect to replace the product or any part of it without charge provided there is proof of purchase. This does not mean an extension of the warranty period.

In the case of a warranty simply call the REMINGTON® Service Centre in your region. This warranty is offered over and above your normal statutory rights.

The warranty shall apply in all countries in which our product was sold via an authorised dealer. This warranty does not include shaving heads / foils and cutters which are consumable parts. Also not covered is damage to the product by accident or misuse, abuse, alteration to the product or use inconsistent with the technical and/or safety instructions required. This warranty shall not apply if the product has been dismantled or repaired by a person not authorised by us



REMINGTON® SERVICE HOTLINE

United Kingdom

 **+44 0800 212 438 (free call)**

Rayovac Europe Ltd,
Watermans House, Kingsbury Crescent,
The Causeway, Staines, Middlesex,
TW18 3BA, UNITED KINGDOM

www.remington.co.uk

