

de Kurzgebrauchsanweisung Saugroboter en Quick reference guide Robot vacuum cleaner

Lesen Sie vor der Inbetriebnahme **unbedingt** die Gebrauchsanweisung.
Dadurch schützen Sie sich und vermeiden Schäden an Ihrem Saugroboter.

To avoid the risk of accidents or damage to the robot vacuum cleaner, it is **essential** to read the operating instructions before using it for the first time.

Vor dem Gebrauch / Preparing for use

Seitenbürsten einsetzen
Insert the side brushes

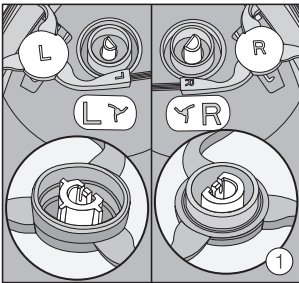

Schutzfolien entfernen
Remove the protective foil

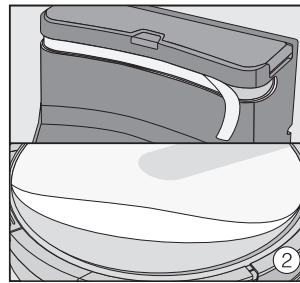

Batterien in Fernbedienung einlegen
Place the batteries in the remote control

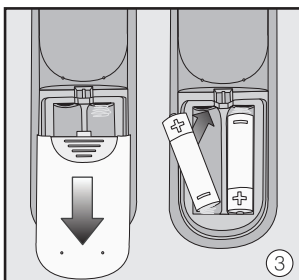

Saugroboter einschalten
Switch on the robot vacuum cleaner

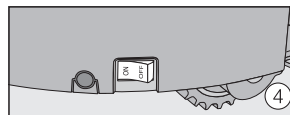

Basisstation anschließen / Connect the base station

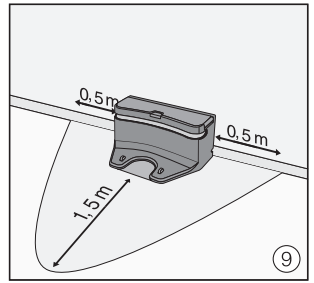
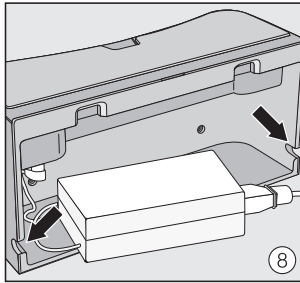
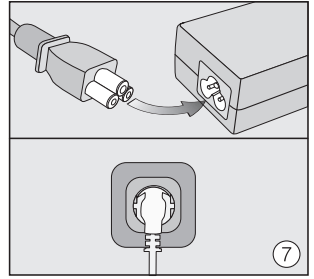
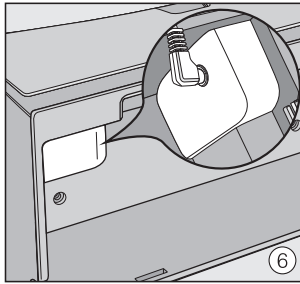
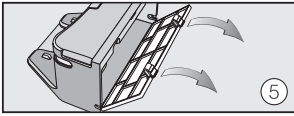

Akkumulator laden / Charge the rechargeable battery

über Basisstation
via base station

ohne Basisstation (+ Abb. 7)
without base station (+ dia. 7)

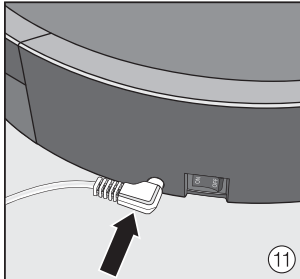
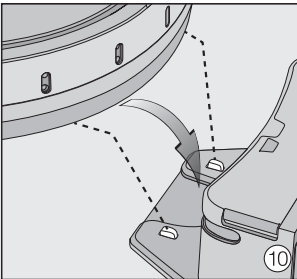

Uhrzeit einstellen
Set the clock

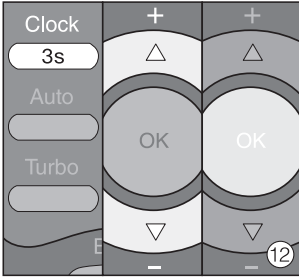

Saugbereich abgrenzen (bei Bedarf)
Define the area to be vacuumed (if required)

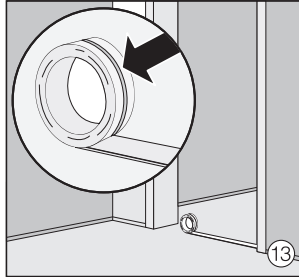

Gebrauch / Use

Ein- und Ausschalten
Switching on and off



Reinigung starten
Starting vacuuming

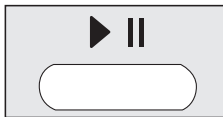

Reinigung unterbrechen
Interrupting vacuuming

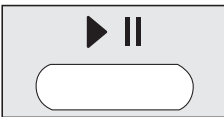

Basisstation ansteuern
Directing to the base station

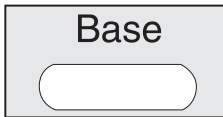

Reinigungsmodus wählen (vier unterschiedliche Reinigungsmöglichkeiten)
Selecting the vacuuming mode (four different vacuuming modes)

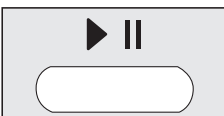
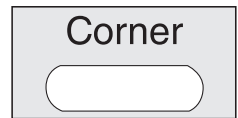
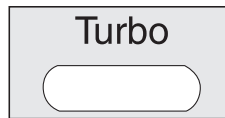
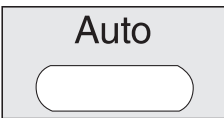

Timer einstellen (nur möglich bei eingestellter Uhrzeit)
Setting the timer (only possible if the clock has been set)

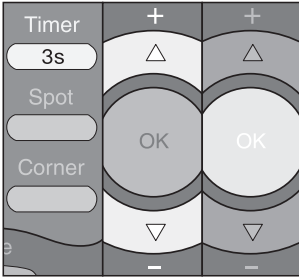

Maximale Überfahrtshöhe reduzieren
Reducing the maximum crossing over height

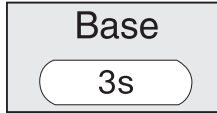

Wartung / Maintenance

Staubbox leeren / Emptying dust box

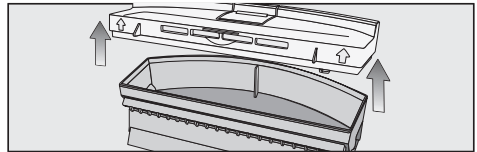
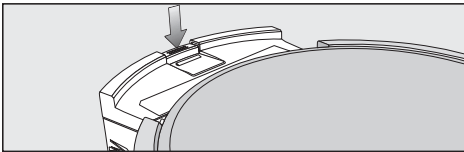

Fehlermeldungen / Fault messages

- F 1** Fehler "Rad abgehoben" / "Wheel raised" fault
- F 2** Fehler "Sensoren verschmutzt" / "Dirty sensors" fault
- F 3** Fehler "Staubbox" / "Dust box" fault
- F 4** Fehler "Überlastung Antriebsräder" / "Drive wheels overloaded" fault
- F 5** Fehler "Überlastung Bürsten" / "Brushes overloaded" fault
- F 6** Fehler "Überlastung Motor" / "Motor overloaded" fault
- F 7** Interner Systemfehler / Internal system fault
- F 8** Fehler "Vorderrad verschmutzt" / "Front wheel dirty" fault

Weitere Informationen finden Sie in der beiliegenden Gebrauchsanweisung.

For further informations please read the main operating instructions supplied with your robot vacuum cleaner.