

Jabra®

JABRA SPORT COACH WIRELESS

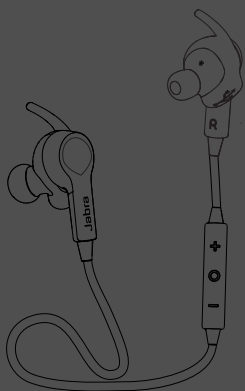

User Manual

jabra.com/sportcoachwireless

A BRAND BY

GN Netcom

© 2015 GN Netcom A/S. All rights reserved. Jabra® is a registered trademark of GN Netcom A/S. All other trademarks included herein are the property of their respective owners. The Bluetooth® word mark and logos are owned by the Bluetooth SIG, Inc. and any use of such marks by GN Netcom A/S is under license. (Design and specifications subject to change without notice).

MADE IN CHINA
MODEL: OTE20



Declaration of Conformity can be found on
www.jabra.com/CP/US/declarations-of-conformity

CONTENTS

1. WELCOME	4
2. HEADSET OVERVIEW	5
2.1 INCLUDED ACCESSORIES	
3. HOW TO WEAR.....	7
3.1 CHANGING EARGELS	
3.2 CHANGING EARWINGS	
3.3 WEARING THE FITCLIP	
3.5 HOW-TO-WEAR VIDEOS	
4. HOW TO CHARGE THE EARPHONES	11
5. HOW TO CONNECT.....	12
5.1 CONNECT TO A NEW OR SECOND MOBILE PHONE	
5.2 CONNECT TO AN NFC DEVICE	
6. JABRA SPORT LIFE APP	14
7. HOW TO USE	15
7.1 CALLS & MUSIC	
7.2 WORKOUT	
7.3 MULTIPLE CALL HANDLING	
8. SUPPORT	19
8.1 FAQ	
8.2 HOW TO CARE FOR YOUR HEADSET	
9. TECHNICAL SPECIFICATIONS	20

1. WELCOME

Thank you for using the Jabra Sport Coach Wireless.
We hope you will enjoy it!

JABRA SPORT COACH WIRELESS FEATURES

- Wireless Sports earphones with Dolby® sound enhancement
- TrackFit Motion Sensor for tracking your indoor running distance, speed and cadence
- Connects to all Bluetooth® Smart devices – phones, computers, tablets and more
- NFC for easy pairing
- Jabra Sport Life app for integrated training management
- Control music and calls directly from the headphones
- IP55 Certified, drop, strength, dirt, temperature & humidity tested

2. HEADSET OVERVIEW

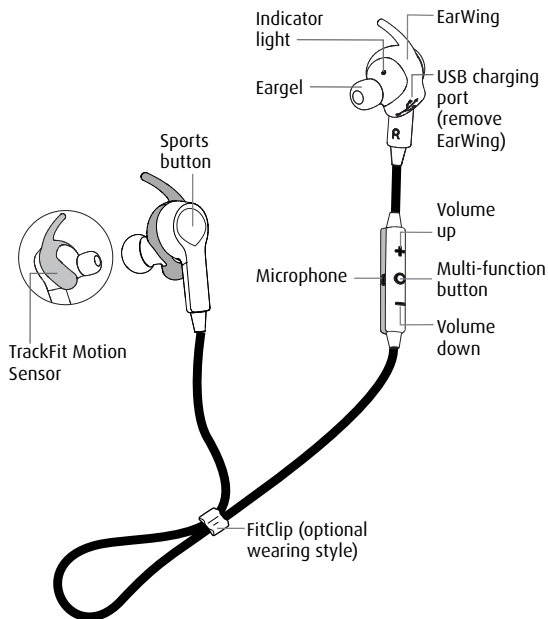

2.1 INCLUDED ACCESSORIES

Eargels



Large



Medium



Small



Extra small

Earwings



Large



Medium



Small



Fitclips



Protective pouch



Micro-USB cable

3. HOW TO WEAR

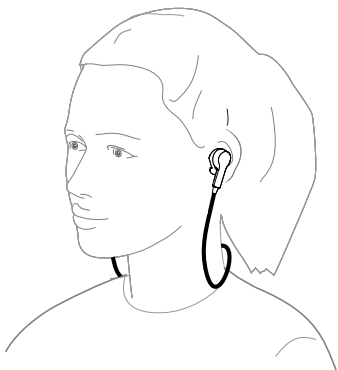

3.1 CHANGING EARGELS

For the optimal audio experience, try the different eargel sizes. The fit should feel tight and secure in your ear.

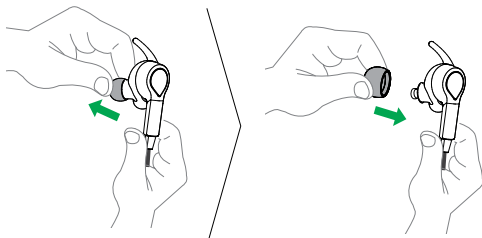

3.2 CHANGING EARWINGS

For the most secure fit during your workout, try each of the different EarWing styles.

1. Remove the current EarWing and pull the new EarWing onto the earbud, as shown. You may have to stretch the EarWing into position.

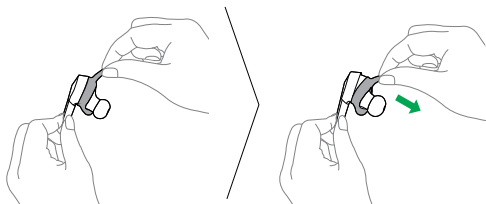

2. The top of the EarWing should fit tight into the ridge of the ear.

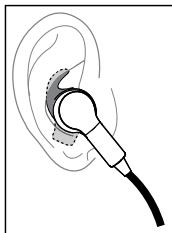

3.3 USING THE FITCLIP

Attach the Fitclip to the cable, and adjust for optimal fit.

REGULAR FITCLIP STYLE

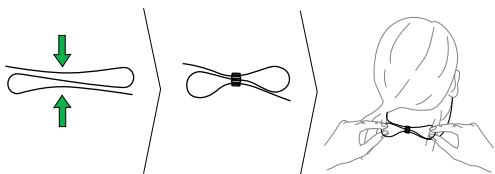

OPTIMAL FITCLIP STYLE

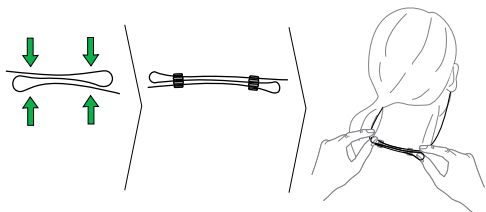

SIMPLE FITCLIP STYLE

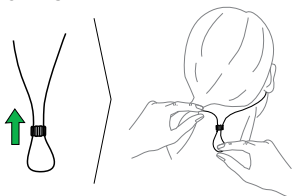

3.4 HOW-TO-WEAR VIDEOS

You can watch how-to-wear videos on jabra.com/sportcoachwireless.

4. HOW TO CHARGE THE EARPHONES

Pull back the EarWing on the right earphone to expose the USB charging port. Plug any USB cable or charger into the USB charging port and connect to power to begin charging.

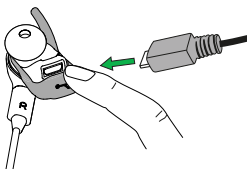

It takes approx. 2 hours to fully charge the earphones.

NOTE: When charging the earphones using a PC, ensure the PC supports USB charging.

5. HOW TO CONNECT

The first time the Jabra Sport Coach Wireless is turned on it will automatically attempt to connect to any mobile phone that has Bluetooth turned on.

5.1 CONNECT TO A NEW OR SECOND MOBILE PHONE

1. Turn on Bluetooth on your mobile phone.
2. Press and hold the **Multi-function** button on the controller until the indicator light on the right earbud flashes blue. Release the button.
3. Follow the voice-guided connection instructions to connect to your mobile phone.

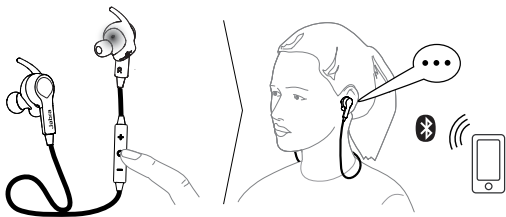

NOTE: If two mobile phones have been connected to the Jabra Sport Coach Wireless, you may need to select which phone will be used for calls/music/workout. Simply open the Bluetooth menu on the mobile phone you wish to use and select the Jabra Sport Coach Wireless from the list of devices.

5.2 CONNECT TO AN NFC DEVICE

1. Turn on NFC on your mobile phone.
2. Ensure the earphones are turned on.
3. Slowly slide the NFC zone of the earphones (back side of the controller) directly against the NFC device until a connection is confirmed.

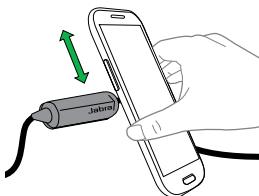

To disconnect, repeat the process.

6. JABRA SPORT LIFE APP

The Jabra Sport Life app is a free app that enables you to create, track and personalize your workouts, listen to on-the-go workout status updates, monitor your heart rate and much more.

Android download - Google Play
iOS download - App Store

7. HOW TO USE

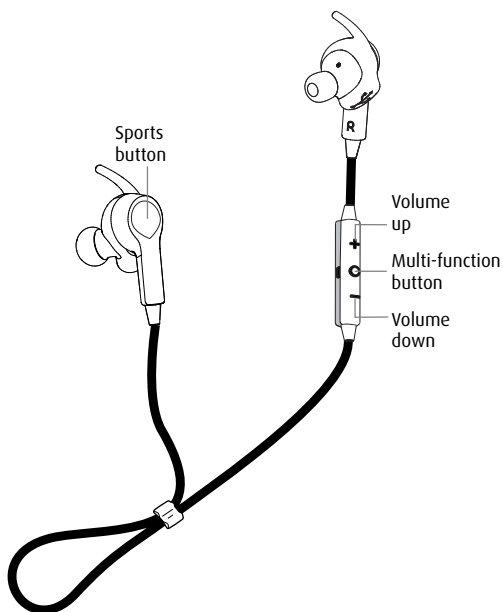

7.1 CALLS & MUSIC

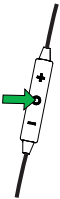
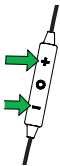
	FUNCTION	ACTION
	Turn on/off	Press and hold (3 sec) the Multi-function button until the indicator light flashes
	Play/pause music	Tap the Multi-function button
	Answer/end call	Tap the Multi-function button
	Reject call	Double-tap the Multi-function button
	Redial last number	When not on a call, double-tap the Multi-function button
	Adjust volume	Tap the Volume up or Volume down button
	Mute	Tap both the Volume up and Volume down button at the same time
	Skip track	Press and hold (2 secs) the Volume up or Volume down button
	Battery status	Tap the Volume up or Volume down button when not on a call or listening to music

7.2 WORKOUT

When the earphones are used with the Jabra Sport Life app (or your regular sport app) you can control your workout and listen to on-the-go workout updates using the **Sports** button.

BEFORE WORKOUT



Start Sport app

Tap the **Sports** button

Start workout

Press and hold (1 sec) the **Sports** button

DURING WORKOUT

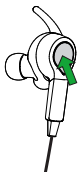

Pause/resume workout

Press and hold (1 sec) the **Sports** button

Listen to On-the-go updates

Tap the **Sports** button

Disable/enable On-the-go updates

Double-tap the **Sports** button

7.3 MULTIPLE CALL HANDLING

The headset can accept and handle multiple calls at the same time.

FUNCTION	ACTION
End current call and answer incoming call	Tap the Multi-function button
Switch between held call and active call	Press and hold (2 secs) the Multi-function button
Put current call on hold and answer incoming call	Press and hold (2 secs) the Multi-function button
Reject incoming call, when on a call	Double-tap the Multi-function button

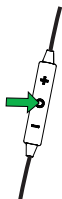

8. SUPPORT

8.1 FAQ

View the FAQs on jabra.com/sportcoachwireless

8.2 HOW TO CARE FOR YOUR HEADSET

- Always store the headset with the power off and safely protected.
- Avoid storage at extreme temperatures (above 65°C/149°F or below -10°C/14°F). This can shorten battery life and may affect the headset.

9. TECHNICAL SPECIFICATIONS

JABRA SPORT COACH WIRELESS	SPECIFICATION
Weight:	16g (0.56oz)
Dimensions:	H 18mm x W 21mm x D 32mm
Microphones:	MEMS microphone
Speaker:	6mm dynamic speaker
Operating range:	10m/33ft (phone dependent)
Bluetooth version:	4.0
Paired devices:	Up to 8, connected to two at the same time (MultiUse™)
Supported Bluetooth profiles:	A2DP (v1.2), Hands Free Profile (v1.6), Headset profile (v1.2), AVRCP (v1.4)
Talk/music time:	Up to 5.5 hours
Standby time:	Up to 10 days
Operating temperature:	-10°C to 55°C (14°F to 131°F)
Storage temperature:	-10°C to 65°C (14°F to 149°F)
Pairing passkey or PIN:	0000

