

Vaporetto®

ECO PRO 3000

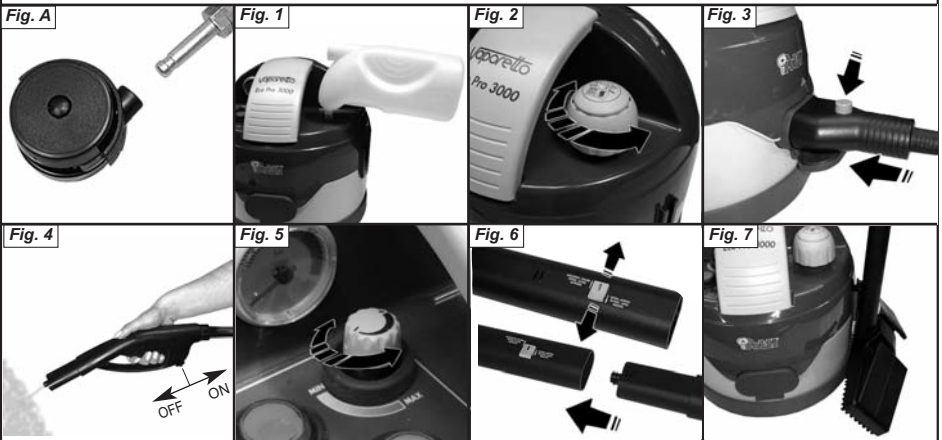

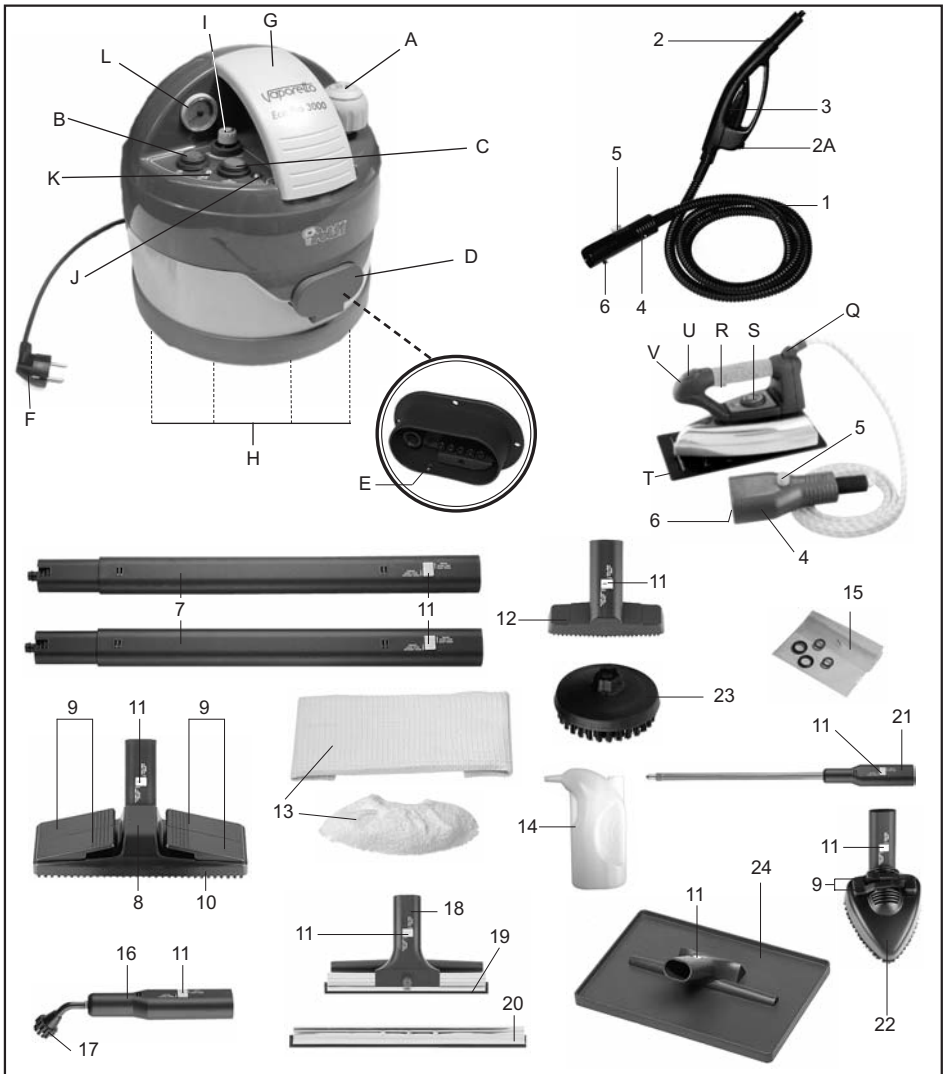

VAPORETTO ECO PRO 3000



Read these instructions carefully before using the appliance.

Dear Customer,

Congratulations and thank you for purchasing this *POLTI* product, contributing to the conservation of our most precious natural resource: the Environment. *VAPORETTO* solves all cleaning and hygiene problems without the use of detergents - all that's needed is just normal tap water which our system transforms into steam at a constant powerful pressure, allowing you to clean more thoroughly and in an ecological way. Our Technical Development team have added a range of sophisticated improvements to make cleaning tasks both safer and more effective:

- The **No Volt System** - a unique *Polti* patent, designed so that there is no electricity to the on/off switch on the handle, making it absolutely safe even if the handle is accidentally brought into contact with liquids. The No Volt System offers the additional safety feature of only being able to operate when the user is present - the steam switches itself off immediately if the handgrip is released.
- This generator is equipped with the new **Super Power feature**. The maximum power is taken up when the machine is being heated from cold to ensure more rapid heating of the water. Once a certain level of temperature has been reached (level 1), a cut out comes into operation, reducing the electricity consumption. The system continues to heat using only the required amount of electricity to reach operating temperature most efficiently (level 2).
- The **Safety Cap** - a unique *Polti* patent, prevents opening whilst any residual pressure remains in the system.
- The water **boiler** is made of a stainless steel 18/10 which resists lime scale and corrosion and extends the life of your appliance.
- Steam pressure is controlled by a pressure switch and the steam flow can be regulated while operating.

Polti's products are submitted to very strict testing. *Vaporetto* passed also the *Splash Proof Test*, since it has been designed to be splash proof.

VAPORETTO is built according to the *IEC* regulations, and is equipped with a safety valve, a safety thermostat and an additional protective thermostat which prevents operation of the machine when it is empty and which maintains *VAPORETTO* in an absolutely safe condition at all times. The accessories and all the components are manufactured with highest quality materials which are resistant to the high temperatures attained during the operation of this machine.

GENERATOR

- A) Patented Safety Cap
- B) Generator on/off switch
- C) Accessory on/off switch
- D) Central connector block with splash proof cover
- E) Lock-in aperture for central connector
- F) Power supply cable
- G) Carrying handle
- H) Pivoting wheels
- I) Steam flow regulation control
- J) "Out of water" indicator light
- K) Steam pressure indicator light
- L) Pressure indicator

- 9) Cloth retaining clips
- 10) Replaceable bristles plate
- 11) Accessories locking button
- 12) Small brush
- 13) Cotton cloths
- 14) Filler bottle
- 15) Spare washers for accessory connections
- 16) 120° accessory
- 17) Small round brush for 120° accessory
- 18) Window squeegee tool
- 19) Small blade for window tool
- 20) Large blade for window tool
- 21) High pressure lance

ACCESSORIES

- 1) Flexible hose
- 2) Steam gun
- 2A) Safety switch
- 3) Steam request lever
- 4) Connector assembly
- 5) Press down connector button
- 6) Locking tab
- 7) Extension tubes
- 8) Large brush

ACCESSORIES SOLD SEPARATELY

- 22) Triangular brush
- 23) Large round brush for 120° accessory
- 24) Wallpaper stripper tool
- Q) Iron
- R) Steam request button
- S) Temperature regulation dial
- T) Iron rest mat
- U) Continuous steam jet button
- V) "Iron heating" indicator light

CE This unit conforms with EC-directives 89/336 as amended by 93/68 (EMC) and 73/23 as amended by 93/68 (low voltage).

Polti S.p.A. reserves the right to change equipment or accessory specification without prior notice.

THE SUPER POWER SYSTEM

This steam generator is equipped with the innovative new Super Power system device, using 2 electric heating elements (a 1250 W working element and a 750 W back-up element) to heat water. They are controlled by a pressure switch with differential calibration designed to guarantee that the appliance provides a better, more constant performance. The appliance absorbs most power when cold, to ensure rapid heating of water in the boiler. Once a certain pressure level has been reached, a cut-out reduces absorption of electricity. The appliance continues heating at reduced pressure until it reaches the correct working pressure. This condition continues during operation, to maintain constant steam temperature and pressure. If continued steam consumption causes the pressure in the boiler to drop below a certain level, maximum power is once again absorbed, rapidly restoring the correct operating pressure. When the iron is in use, it will not begin heating until the first pressure level has been reached. This feature guarantees optimal performance and heats water faster when the appliance is first turned on.

PRECAUTIONS

KEEP THESE INSTRUCTIONS

- Read these instructions for use carefully before using the appliance, and make sure that anyone using the machine is familiar with these instructions and the warnings.
- **DO NOT USE THE STEAM FUNCTION ON DRAYLON, VELVET, LEATHER OR OTHER SENSITIVE FABRICS.**
- Any use which does not comply with these instructions will invalidate the warranty.

- The wiring system to which the appliance is connected must always comply with the laws in force.
- Before connecting the appliance, make sure that the mains voltage is the same as the voltage indicated on the data label of the appliance and that the power outlet is connected to earth
- Always turn off the appliance at the on/off switch before unplugging it.
- If the appliance is left unused, always disconnect it from the mains. Never leave the appliance unattended with the cable plugged into the mains.
- Always make sure the appliance is unplugged before performing maintenance work of any kind
- Do not pull the power cable out of the socket, but grasp the plug itself to avoid damage to the socket.
- Do not allow the power cable to be twisted, crushed, stretched, or come into contact with sharp or hot surfaces.
- Do not use the appliance if the power cable or other important parts are damaged.
- Do not use electric extension leads that are not authorized by the manufacturer, as they may cause damage or fire.
- If it is necessary to replace the power supply cable, please refer to the nearest Polti authorised service centre, since the use of a special tool is necessary.
- Never touch the appliance with wet hands or feet with the cable plugged into the mains.
- Do not use the appliance when barefoot.
- Do not use the appliance near a bathtub, shower or container full of water
- Never immerse the appliance, the cable or the plugs in water or another liquid.
- Use of the appliance in places where there is a danger of explosions is prohibited.
- Do not use the product with toxic substances.
- Do not lay the hot appliance on surfaces sensitive to heat.
- Do not leave the appliance exposed to wind or rain.
- Do not place the appliance near a live ele-

ment, an electric stove or any other source of heat.

- Do not expose the appliance to extreme temperatures
- Never let children or people who are not familiar with how the appliance works use it.
- Do not press the buttons hard or with a pointed object such as a pen.
- Always rest the appliance on a stable surface.
- In case of accidental fall of the appliance it is necessary to have it checked by an authorized Polti Service Centre as the internal safety features may have been affected.
- In case of breakdown or malfunction switch off the appliance and never attempt to disassemble it, but refer to an authorized Service Centre.
- To avoid prejudicing the safety of the appliance, use only original spare parts and accessories approved by the manufacturer.
- Do not wind the power cable around the appliance, especially when the appliance is still hot.
- During refilling with water, switch off and disconnect the appliance from the mains.
- It is necessary to keep the unit in horizontal position during operation.
- Do not direct the steam jet onto electrical and/or electronic appliances.
- Let the appliance cool down before cleaning it.
- Before storing the appliance make sure that it has completely cooled down.
- This appliance is equipped with safety devices which are to be replaced only by a suitably qualified technician.
- Do not direct the steam jet at people, animals or debris.
- Never place your hands inside the jet of steam.



ATTENTION:
Danger of burns!

- When Refilling the boiler, use **HOT** rather than cold water, pour in gently at first and keep exposed skin and your face away. Otherwise the still hot tank walls can spit

drops of very hot water or steam spray.

- Do not put any detergent or chemical substance in the boiler. Water by its nature contains magnesium, mineral salts and other deposits which in hard water areas can contribute to limescale build up in the boiler. To avoid these problems, it is necessary to swill out with tapwater and empty the boiler after every 3 or 4 uses. In very hard water areas we recommend the use of our KALSTOP, a special natural-base decalcifier which inhibits and breaks down limescale, making it easy to remove just by swilling out the tank with a little tapwater. This is a preventive against scale build-up and protects the metal walls of the steam generator tank. KALSTOP is available from Polti dealers or by mail-order from your Polti Service Centre.
- **We recommend you use original Polti products only, as products of other brands may not be suitable for use in Polti products and could cause damage.**
- **Never use distilled water or scented water.**
- Make sure the patented safety cap is fully and correctly screwed on, otherwise you may experience steam escaping from around the cap.
- Check periodically the safety cap and **MAKE SURE** the rubber gasket is in place around the base of the screw thread. Replace with original spare parts if necessary. **DO NOT USE** the appliance if the rubber gasket is not in position.
- Do not refill the tank while it is still hot, allow it to cool down for a few minutes before refilling.
- Do not empty the appliance when the water in the boiler is still hot.
- Do not try to unscrew the safety cap when the appliance is in use.
- If you iron sitting down, do not put your legs under the ironing board, the steam can cause burns.
- Iron only on heat resistant surfaces and on surfaces that allow the steam to escape, e.g. mesh ironing boards.
- The iron must be used and rested on a sta-

ble surface.

- When placing the iron on its stand, make sure that the surface on which the stand is placed is stable.
- This appliance is not intended for use by persons (including children) with reduced physical, sensory or mental capabilities, or lack of experience and knowledge, unless they have been given supervision or instruction concerning use of the appliance by a person responsible for their safety.
- Children should be supervised to ensure that they do not play with the appliance.

CORRECT USE OF THE PRODUCT

This appliance is intended for home use as a steam cleaner as described and in accordance with the instructions provided in this manual. Please read these instructions carefully and keep them, as you may find them useful in future

Polti declines liability for any damage or accident derived from any use of Vaporetto which is not in conformity with the instructions contained in this booklet.

ATTENTION

Directive 2002/96/EC (Waste Electrical and Electronic Equipment - WEEE): information for users

This product complies with EU Directive 2002/96/EC.

The crossed-out wastebasket symbol on the appliance means that at the end of its useful lifespan, the product must be disposed of separately from ordinary household wastes.



The user is responsible for delivering the appliance to an appropriate collection facility at the end of its useful lifespan.

Appropriate separate collection to permit recycling, treatment and environmentally compatible disposal helps prevent negative impact on the environment and human health and promotes recycling of the materials making up the product. For more information

on available collection facilities, contact your local waste collection service or the shop where you bought this appliance.

IMPORTANT

Before leaving our factory all our products are rigorously tested. For this reason, your VAPORETTO may contain some residual water in the boiler from the testing.

SET UP

Before using VAPORETTO for the first time assemble the pivoting wheels as indicated in the Fig. A.

PREPARATION FOR USE

1. Unscrew the patented safety cap (**A**) and fill the boiler with about 2 litres of water using the filler bottle (**14**) making sure that it does not overflow (fig. 1). Normal tapwater can be used. However, as hard water by its nature contains limestone, which may cause a build-up of limescale in the tank, in hard water areas we recommend the use of our natural-base decalcifier KALSTOP, available from your Polti dealer or by mail order from your Polti service Centre.
2. Carefully screw on the safety cap to hand tight (Fig. 2). Make sure the patented safety cap (**A**) is fully and correctly screwed on, otherwise you may experience steam escaping from around the cap.
3. Connect the power supply cable (**F**) into an earthed power supply of the correct voltage.

WARNING: Do NOT under any circumstances put or leave the filler bottle in the water filling aperture of the appliance when the appliance is connected to the mains electricity supply. Danger of burns!

INSTRUCTIONS FOR USE

- 1a. Press down the generator on/off switch (**B**) and the accessories on/off switch (**C**) which will light up together with the pressure indicator light (**K**).
- 2a. Open the cover of the central connector block (**D**) and insert the central connector (**4**) pressing the connector button (**5**) and

taking care that the locking tab (6) is correctly positioned in the lock-in aperture (E) on the block (Fig. 3).

- 3a. When the pressure indicator (K) goes off, the steam cleaner is ready for use
- 4a. The steam gun (2) is equipped with a safety switch (2A) which prevents the accidental start of the steam jet by children or people who do not know how to operate the appliance. With the switch 2A in the "OFF" position, the lever controlling the steam jet is locked. Should the hose be left unattended for a moment whilst the appliance is connected to the mains, it is recommended to put the safety switch in the "OFF" position. To start the steam jet, move the 2A switch backwards (ON) and push the steam request lever (Fig. 4).

The first burst of steam may contain some water droplets, due to imperfect thermic stabilisation inside the flexible hose. We would therefore advise that the first jet of steam is played onto an old cloth until a constant pressure of steam is obtained.

Note: The pressure indicator (K) may go on and off from time to time during use of VAPORETTO. This indicates the machine maintains the correct and constant pressure and is quite normal. If the flexible hose is too much twisted during use, the NO-VOLT device stops the steam flow. To resume the steam release, press the steam request lever.

STEAM REGULATION FEATURE

VAPORETTOs are equipped with a steam regulator control (I) (Fig. 5). You can increase the steam flow by turning the control in an anti-clockwise direction. Turning it in a clockwise direction reduces the steam flow. Here are some suggestions for the choice of steam flow level:

- Strong steam: for encrusted dirt, stains, sanitising, grease.
- Normal steam: for carpets, rugs, glass, tiles etc.
- Delicate steam: for vaporising plants and cleaning delicate fabrics, upholstery, wallpaper etc.

Please read separate warning about use on draylon, velvet and other delicate fabrics, or on sensitive wood surfaces.

CONNECTION OF ACCESSORIES

All the accessories of VAPORETTO can be connected to the handle or to the extension tubes as follows (fig. 6):

- 1b. Move the locking button (11) on the accessory to the "open" position.
- 2b. Attach the required tool to the hand gun or to the extension tube.
- 3b. Move the locking button (11) back to the position 'closed'.
- 4b. Check that the connector button has engaged and the accessory is fully connected.

USE OF THE ACCESSORIES HOLDER

The accessories holder allows to fix the tube with the brush mounted on it on the appliance body.

Reposition on the appliance body: make the groove on the back of the brush slide into the guide of the accessories holder on the appliance (Fig. 7).

PRESSURE INDICATOR

Vaporetto is equipped with an indicator (L) displaying operating pressure.

PATENTED SAFETY CAP / "WATER OUT"

The appliance is equipped with a safety cap, which prevents opening of the generator as long as there is any pressure remaining inside. This is an important and indispensable safety device, and it is necessary to follow certain procedures when re-filling the tank. According to model, 'water out' is indicated by a warning light (J), or by an audible alarm signal from the machine, or on more basic models by the exhaustion of the steam output.

Whenever you have used up all the water in the tank, follow the following procedures:

- 1c. Switch off the machine at the generator on/off switch (B)
- 2c. Press the steam request lever (3) on the steam gun (2) or, if using the iron, the steam request button (R) on the iron (Q) so as to fully exhaust the steam supply from the tank.
- 3c. Switch OFF the accessory on/off switch (C).
- 4c. Disconnect the power supply cable (F)

from the mains.

- 5c. Unscrew anti-clockwise the patented safety cap (A)
- 6c. Wait for a few minutes to allow the generator tank to cool down.
- 7c. When cool, proceed to carefully refill the tank as described in paragraph 1 of the section "Preparation for Use". If refilling the generator when not completely cooled, we recommend that you carefully pour only very small quantities of water at each pouring into the tank, so as to avoid spitting from the tank and cover exposed skin and face whilst filling.

USE OF THE PROFESSIONAL IRON (optional accessory)

- 1d. Connect the connector assembly at the end of the iron hose (4) to the generator as shown in point 2a of the section "Instructions for Use".

Check the manufacturer's label on the garment, and interpret the symbol on the label as follows:



Steam ironing allowed--set the dial to its MAXIMUM travel at the end of the 3 dots symbol on your Polti iron



Steam ironing allowed--set the dial to its MAXIMUM travel at the end of the THREE (nb THREE, not two) dots symbol on your Polti iron



DRY IRON only, with iron dial set at one dot. N.B. NEVER CALL FOR STEAM BY PRESSING STEAM REQUEST BUTTON when DRY ironing. See special instructions for DRY ironing in the instruction book.



DO NOT IRON. Neither steam nor dry ironing allowed.

STEAM IRONING

- 2d. For STEAM ironing, turn the dial (S) and set the iron temperature to its maximum travel on the "COTTON-LINEN" steam position.

NB YOU MUST SET AT ITS MAXIMUM POSITION, DO NOT SET AGAINST PICTURE OF THE IRON ON THE DIAL (S).

Most types of fabric, other than delicates

can be STEAM ironed at this temperature, please consult the garment manufacturer's instructions on the label.

NB fabric indications on dial are for DRY ironing, NOT steam ironing.

- 3d. Wait for a few minutes until the "Iron heating" indicator light (V) goes off, to show that the soleplate of the iron has reached the required temperature.
- 4d. Press the steam request button (R) to enable the steam to come out. The steam flow will stop when the button is released. After each filling, when you first start to use the iron, a few drops of water mixed with the steam may be emitted (due to imperfect heat stabilisation). It is therefore advisable to direct the first jet of steam onto a rag.
- 5d. The iron can also be used in a vertical position e.g. for removing creases from curtain, clothing etc.
- 6d. To obtain a continuous jet of steam move the sliding button (U). The steam will continue to come out even when the steam request button (R) is released. To stop the flow of steam push the sliding button (U) backwards.

NOTE: using the iron, it is advisable to adjust the steam jet at medium output, or to do some testing in order to find the jet which is most suitable to the fabric to be ironed.

RECOMMENDED TECHNIQUE for steam ironing with the Polti iron is to APPLY steam (button R) on the upstroke, then release button R (so no steam) for the backstroke, thus reclosing the fibres, preventing oversteaming and wetness.

DRY IRONING

- If you need to DRY iron (ONLY) (NOT steam ironing), press the accessory on/off switch (C) and adjust the temperature of the iron by setting the dial (S) to the temperature required for the fabric (as shown on the dial).

ATTENTION: when dry ironing, be careful not to press the steam request button (R), as hot water could come out of the iron onto your garment and board.

IMPORTANT

- Do not leave the iron unattended whilst connected to the mains.
- Iron only on heat resistant surfaces and on surfaces that allow the steam to escape e.g. **MESH** ironing boards.
- **ATTENTION:** if you iron sitting down, do not place your legs under the ironing board, the steam can cause burns.

TIPS FOR BETTER UNIT PERFORMANCE

WARNINGS

- DO NOT USE ON leather, wood or delicate fabrics especially dralon, velvet and other pile surfaces.
- For cleaning leather, wood or delicate fabrics especially dralon, velvet and other pile surfaces, consult the manufacturers instructions. Clean only by using the hand gun at a safe distance together with a soft cloth and always do a test on a non visible part of the item first or on a sample. Allow the test area to dry completely before observing results and effects on surface or colour before proceeding to clean further areas.
- For cleaning wood surfaces (furniture, doors etc.) take great care as a too long application of the steam could alter the waxed appearance, the shine or the colour of the surfaces cleaned. We therefore recommend you to apply the steam on such surfaces only for brief periods or to clean these surfaces using a cloth first held in the steam.
- Please pay particular attention while cleaning brick floors: a too long application of steam could damage wax, brightness or colour of these surfaces.
- For delicate surfaces (e.g. synthetic materials, lacquered surfaces etc.) we recommend that the small brush should always be covered with at least two cloths to reduce the intensity of the steam, and (on machines with steam variation control) with the steam set at low level. Always test first on a non-visible area, allow to dry thoroughly, and if successful, make sure to use exactly the same tool, technique, steam level and steam jet distance.
- If cleaning glass surfaces in particularly low

temperatures preheat the glass using the hand gun from about 50 centimetres distance from the surface to be cleaned.

- For care of your plants vaporise at a minimum distance of 50 centimetres.

STEAM GUN (2)

The steam gun can be used directly on all spots requiring a stronger, closer treatment without connecting the brushes. The more resistant the stain, the closer you should hold the gun, the steam pressure and temperature being higher at the source. Always wipe with a dry cloth (or a slightly abrasive sponge if the spot is a difficult one to remove) after using the gun. Steam gun is particularly efficient at:

- breaking down rug and carpet stains before they are treated with the large brush;
 - cleaning stainless steel surfaces, panes, mirrors, enamelled surfaces;
 - cleaning hard-to-reach corners, such as stairs, window sills, door posts;
 - cleaning cooking top knobs, taps bases
 - cleaning window shutters, heaters, car interiors;
 - spraying plants (from a distance);
 - removing odours and creases from clothes.
- To reach higher points, the steam gun can be connected to one or both extension tubes.

LARGE BRUSH (8)

To wash floors, put a clean, dry kitchen cloth under the brush and swing back and forth without applying any pressure. Use the other side of the cloth when the first one is impregnated with dirt. Use the brush directly without the cloth on particularly dirty or incrusted areas and in spaces between the tiles: swing the brush sideways to detach the dirt. Highly obstinate stains may require a steam gun treatment before the brush and cloth are used (an old bath towel is an ideal cloth). Apply the same procedure to ceilings and vertical surfaces, like wallpaper. The cloth can easily be fastened around the brush and held in place by the 4 clips (9) on the brush itself. Smooth cotton cloths are suitable for the treatment of glass surfaces: fasten the cloth around the brush then pass it over the window pane (or mirror) to remove the greasy film. Finally, spray the surface with the steam gun and wipe dry with a clean cloth. In cold

weather, window panes will require pre-heating with the steam gun (from a distance of 50 cm), prior to the actual cleaning with the brush. VAPORETTO is ideal for both syntetic and wool rugs as well as for all types of carpets. Its use ensures total hygiene, revives colours and restores the original brilliance of the pile. Drying occurs practically at once. Fold a cotton cloth over 2 or 3 times (according to the length and resistance of the pile) and fasten it onto the brush. Move the brush rapidly in all directions without applying any pressure. You should avoid lingering in the same place, as this may soak the area. The treatment can be repeated as frequently as you wish, with no damage whatsoever. Drying occurs practically at once. Particularly dirty rugs may need several treatments. Obstinate stains may require the use of the steam gun (at a distance of 5-10 cm) prior to treatment.

SMALL BRUSH (12)

The small brush is used whenever the big brush is too big or not practical to be used.

The small brush can be connected directly to the steam gun or to the extension tubes. The small brush can be used on:

- furnishing fabrics (after testing on small parts)
- velvets and leather (not too close)
- car linings, car windows
- small window surfaces
- tile and other small surfaces

To clean wood (doorposts , floors etc) do not apply the steam directly but cover the brush (big or small) with a doubled cotton cloth. For furniture cleaning, direct the steam jet onto a dry cotton cloth, and then start the cleaning. The warm moisture on the cloth traps the dust, spots and the static electricity so that the furniture stays clean longer.

120° STEAM ACCESSORY (16)

The 120° accessory (which can be connected directly to the gun or together with the extension tubes) allows you to concentrate a powerful jet of steam to otherwise inaccessible locations, such as radiators, door posts, sills and shutters, as well as for sterilising toilet bowls. It's a very useful and indispensable tool.

WINDOW SQUEEGEE TOOL (18,19,20)

The window squeegee tool allows you to clean effectively and rapidly all glass surfaces without using detergents. Your glass will remain cleaner longer thanks to the absence of the film normally left behind by chemical cleaning products on which new dust and grease can attach themselves.

Cleaning glass is done in two stages:

- Spray the steam onto the surface to be cleaned to loosen the dirt (not touching with the blade).
- Pull the blade straight down the window surface from top to bottom without applying the steam, to take away the dirt.
- To clean especially large glass surfaces, attach the window squeegee tool to the extension tubes.

LONG STEAM LANCE (21)

This accessory allows you to reach the most inaccessible places. Ideal for cleaning large radiators or shutters etc.

CARE OF YOUR VAPORETTO

- Before attempting any maintenance operation, make sure to always disconnect the appliance from the mains
- **Check periodically the condition of the coloured washer connections on the central connector (4). If necessary, replace the washers with the spare washers supplied (15).**

Make the same check also on the connection washers of the extension tubes (7) and of the steam gun (2).

- To clean the body of the appliance, simply use a moist cloth.

**INCREASE THE VERSATILITY OF
VAPORETTO EVEN FURTHER WITH
THE FOLLOWING OPTIONAL
ACCESSORIES**

PROFESSIONAL IRON

Aluminium soleplate with 21 holes concentrated at the tip. Cork handle and ergonomic steam release button. Equipped with iron-rest mat.

PROFESSIONAL STRENGTH PRESSING IRON MODEL INOX

Stainless steel soleplate with 11 holes concentrated at the point. Indicator light to indicate the selected temperature has been reached. Heat resistant iron rest mat.

TRIANGULAR BRUSH (22)

A new accessory whose shape allows access into the most difficult corners.

LARGE ROUND BRUSH FOR 120° ACCESSORY (23)

A very useful new accessory which allows the 120° steam nozzle to be used for cleaning larger surfaces.

WALLPAPER STRIPPER TOOL (24)

Specially designed for easy removal of wallpaper without significant wetting.

