



WD TV® Live Hub

Media Center





1

US/JA/TW EU/KO UK CH AU/NZ



US/JA/TW EU/KO UK CH AU/NZ

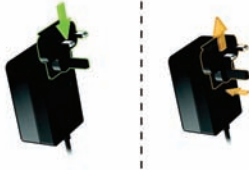

2

Cables sold separately



Composite cable

or



or



Component cable

HDMI
HIGH-DEFINITION MULTIMEDIA INTERFACE

3



Ethernet cable sold separately.

4



WD Discovery Tool



<http://products.wdc.com/WDTVLiveHub>

5



6





User Manual



<http://products.wdc.com/WDTVLiveHub>

Minimum Installation Requirements

Standard or HD television with HDMI, YPbPr, or composite video input.

Requisiti minimi di installazione

Telesvisore standard o HD con ingresso video HDMI, YPbPr o composito.

Requisitos mínimos de instalación

Televisión estándar o HD con HDMI, YPbPr o entrada de vídeo compuesto.

Requisitos Mínimos de Instalação

Televisão HD ou padrão com HDMI, YPbPr ou entrada para vídeo composto.

Minimale installatievereisten

Standaard- of HD-televisie met HDMI-, YPbPr- of composietvideo-ingang.

Минимальные требования для установки

Телевизор (обычный или HD) с видеовходом составного сигнала, HDMI или YPbPr.

Mindestanforderungen zur Installation

Standard- oder HD-Fernsehgerät mit HDMI-, YPbPr- oder Composite Video-Eingang.

Configuration système requise

Téléviseur standard ou HD avec entrée HDMI, YPbPr ou vidéo composite.

Minimalne wymagania instalacyjne

Odbiornik telewizyjny standardowy lub HD z wejściem sygnału HDMI, YPbPR lub kompozytowego wizji (Composite).

Minimum installationskrav

Standard eller HD TV med HDMI, YPbPr eller komposit videoudgang..

الحد الأدنى من متطلبات التثبيت

• تلفزيون قياسي أو عالي التعريف HD مزود بمدخل فيديو HDMI أو YPbPr أو فيديو مركب.

Minimum Kurulum Gereksinimleri

HDMI, YPbPr veya bileşik video girişi içeren Standart ya da HD televizyon.

Minimální požadavky pro instalaci

Běžný televizor nebo televizor s vysokým rozlišením HD s kompozitním, HDMI nebo IPbPr video vstupem.

Minstekrav for installasjon

Standard eller HD-TV med HDMI, YPbPr eller sammensatt videoinnmatning.

Ελάχιστες απαιτήσεις εγκατάστασης

Τυπική τηλεόραση ή τηλεόραση HD με HDMI, YPbPr ή σύνθετη είσοδο βίντεο.

Asennuksen vähimmäisvaatimukset

Tavallinen tai HD-televisio, jossa on HDMI-, YPbPr-tai komposiittivideosisääntulo.

Lägsta krav för installation

Standard- eller HD-TV med HDMI-, YPbPr eller kompositvideoingång.

Minimálne požiadavky na inštaláciu

Štandardný televízor alebo televízor s rozlíšením HD so vstupom HDMI, kompozitným alebo IPbPr vstupom pre video.

最小インストール要件

HDMI、YPbPr またはコンポジットビデオ信号入力が装備された標準 TV または HD TV。

최소 설치 요구 사항

HDMI, YPbPr 또는 합성 비디오 입력이 있는 일반 또는 HD TV.

最低安裝需求

具有 HDMI、YPbPr 或複合視訊輸入的標準或 HD 電視。

最低安裝要求

帶 HDMI, YPbPr 或複合視頻輸入的標準或 HD 電視。

Technical Support Services

<http://support.wdc.com>
www.westerndigital.com



If you encounter problems with this product, please contact WD Technical Support.

North America

English 800.ASK.4WDC (800.275.4932)

Spanish 800.832.4778

Asia Pacific

+800.6008.6008

Japan 00 531 650442

Europe (toll free*)

00800.27549338

* Austria, Belgium, Denmark, France, Germany, Ireland, Italy, Netherlands, Norway, Spain, Sweden, Switzerland, United Kingdom

Europe (non toll free) +31.880062100

Middle East

+31.880062100

Africa

+31.880062100

Western Digital, WD, the WD logo, and WD TV are registered trademarks of Western Digital Technologies, Inc. in the U.S. and other countries. Other marks may be mentioned herein that belong to other companies. Specifications subject to change without notice.

© 2010 Western Digital Technologies, Inc.
All rights reserved.

Western Digital
20511 Lake Forest Drive
Lake Forest, California U.S.A. 92630

4079-705060-800 Jul 2010



Manufactured under license under U.S. Patent #'s: 5,451,942; 5,956,674; 5,974,380; 5,978,762; 6,487,535 & other U.S. and worldwide patents issued & pending. DTS and the Symbol are registered trademarks, & DTS 2.0+ Digital Out and the DTS logos are trademarks of DTS, Inc. Product includes software. © DTS, Inc. All Rights Reserved.



Manufactured under license from Dolby Laboratories. "Dolby" and the double-D symbol are trademarks of Dolby Laboratories.



HDMI, the HDMI logo and High-Definition Multimedia Interface are trademarks or registered trademarks of HDMI Licensing LLC.

This product incorporates copyright protection technology that is protected by U.S. patents and other intellectual property rights. Use of this copyright protection technology must be authorized by Rovi Corporation, and is intended for home and other limited viewing uses only unless otherwise authorized by Rovi Corporation. Reverse engineering or disassembly is prohibited.

Do not connect the unit through a VCR. Video signals fed through VCRs may be affected by copyright protection systems and the picture will be distorted on the television.

WD respects the rights of copyright owners to control the uses of their intellectual property.